



# Sierra Components, Inc.

2222 Park Place • Suite 3E • Minden, Nevada 89423

Phone: 775.783.4940 Fax: 775.783.4947

Chip back potential is the level which bulk silicon is maintained by on-chip connection, or it is the level to which the chip back must be connected when specifically stated below. If no potential is given the chip back should be isolated.

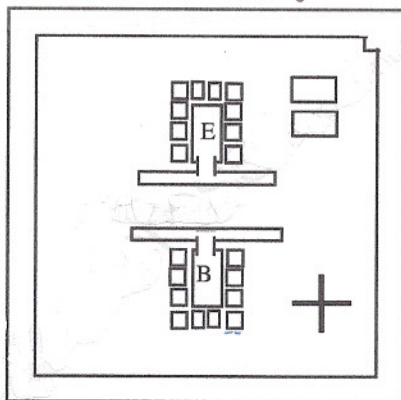

E = EMITTER  
B = BASE

BACKSIDE = COLLECTOR

EUTECTIC DIE ATTACH AND 1 MIL GOLD WIRE RECOMMENDED

**Top Material: AU**  
**Backside Material: AU**  
**Bond Pad Size:**  
**Backside Potential: Collector**  
**Mask Ref:**

**APPROVED BY: MG**

**DIE SIZE : 14 X 14 Mils**

**DATE: 3/31/11**

**MFG: Ditech**

**THICKNESS:**

**P/N: BFR96**